

Tri-City River Trail: Watertown Riverfront

The mile-long multi path restoration project presented here will dramatically increase access to the shore of the Charles River just below Watertown Square. It is the first phase of a five kilometer Tri City River Trail serving Boston, Newton, and Watertown – a critical link in the regional trail system.

A public private partnership of the Department of Conservation and Recreation, the City of Watertown, the Perkins School for the Blind, and the Lawrence and Lillian Solomon Fund hired Sasaki Associate, one of the leading design firms in the country, to produce this design. After two years and hundreds of hours of community effort a final design has been approved by the DCR and will be ready for bid this spring. Funding is now being sought to implement this project.





Watertown

Cambridge

Boston

Newton

Charles River Basin

Partnership roles: steps one and two complete

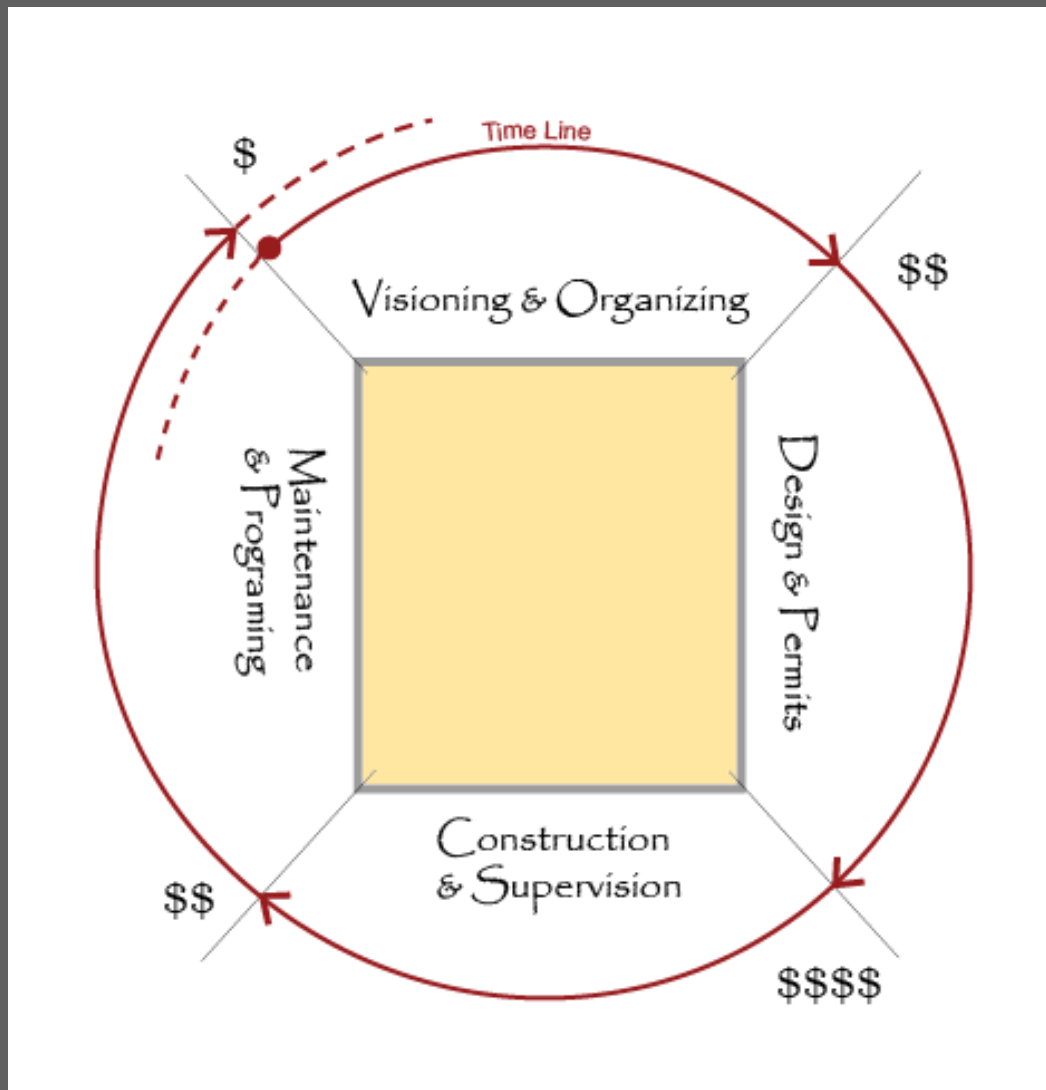

A Tri City River Trail



Newton

Watertown

Boston

Phase One:
The
Watertown
riverfront



Users of the park



Bicycle access

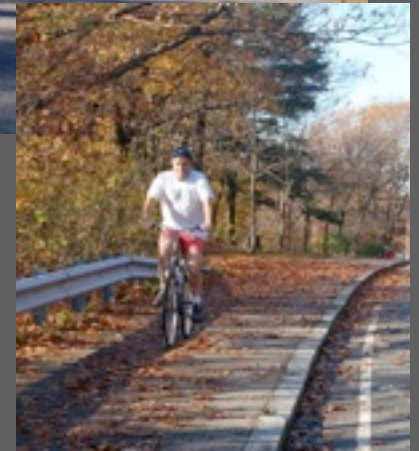

Barriers to use



The conditions on the ground



The conditions on the ground



Severe Erosion



The hidden river



Open vistas along a stone clad shore



NEIGHBORHOOD TO RIVER

RECONNECTING RIVERFRONT PARK TO ITS COMMUNITY



WHAT IS RIVERFRONT PARK ?



PARKWAY

WHAT IS THE PARK ?



PARKWAY



PLAYGROUND

WHAT IS THE PARK ?



PARKWAY



PLAYGROUND



PATHWAY
with river access

WHAT IS THE PARK ?



ECOLOGICAL
CORRIDOR

DESIGN ELEMENTS

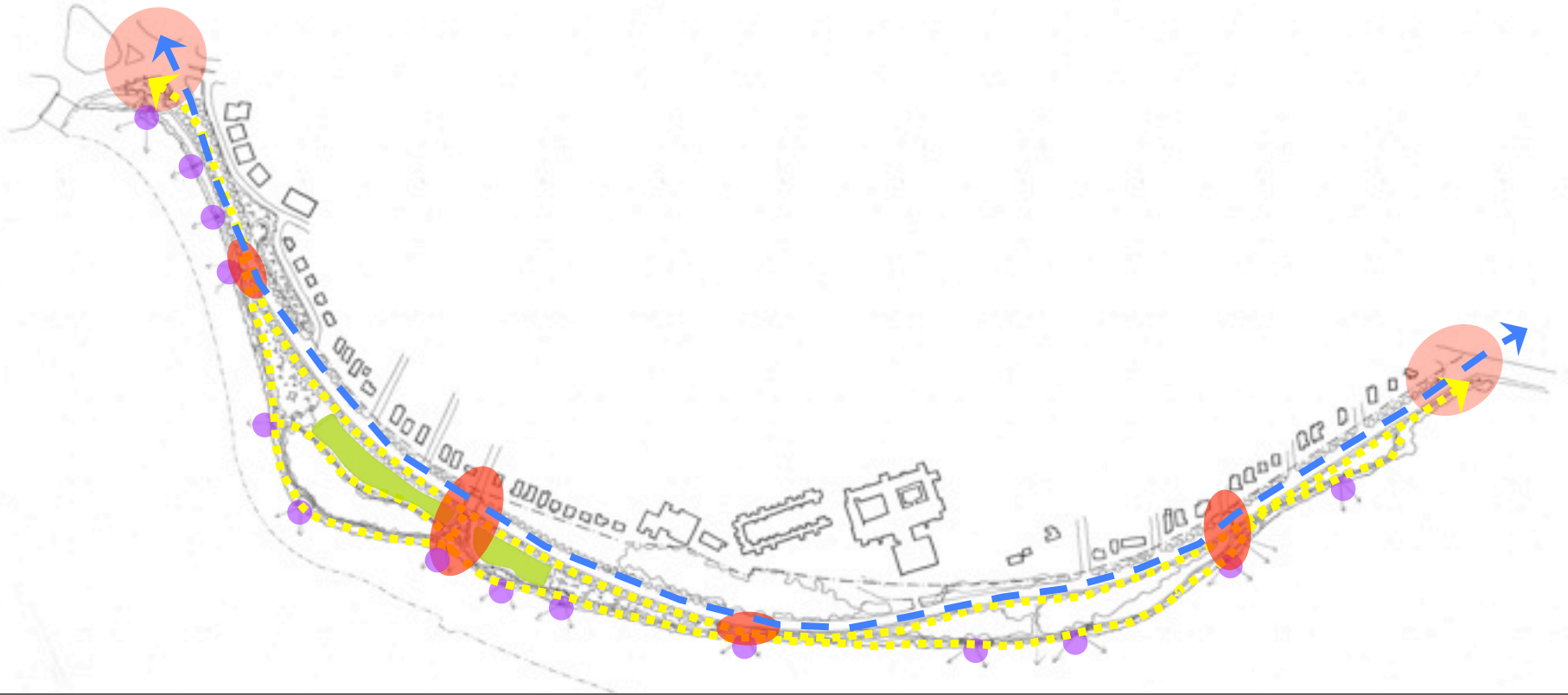

- — Parkway
- Entrance / Transition zones
- Pathways
- Visual or direct access to water

PARKWAY & SIDEWALK - Existing Conditions

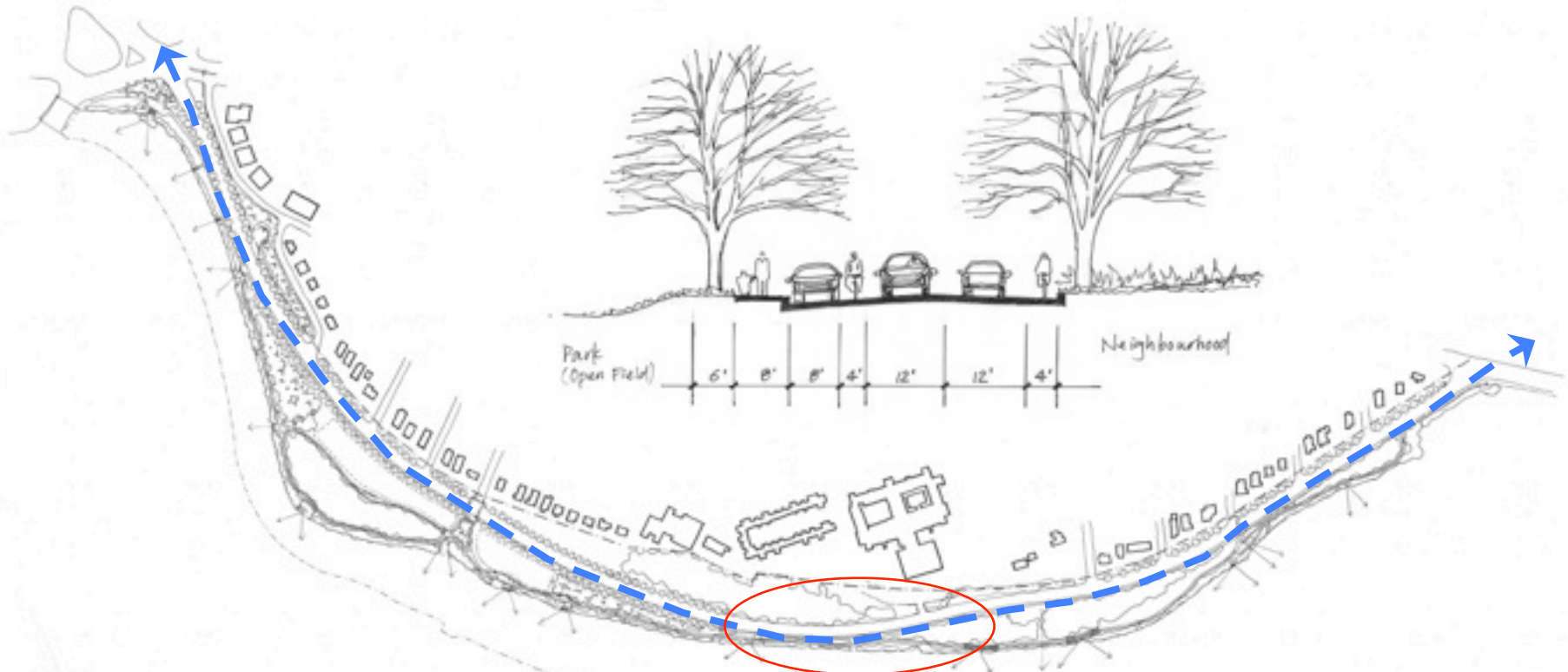

Gap in walkway



Gap

PEDESTRIAN CIRCULATION - Proposed



- Concrete Sidewalk - 5-8'
- Soft Path - 6 to 8'
- Braille Trail
- Hiking Trail - 3'

RIVER ACCESS + BANK STABILIZATION



- Key points of access

RIVER ACCESS TYPE + BANK STABILITY

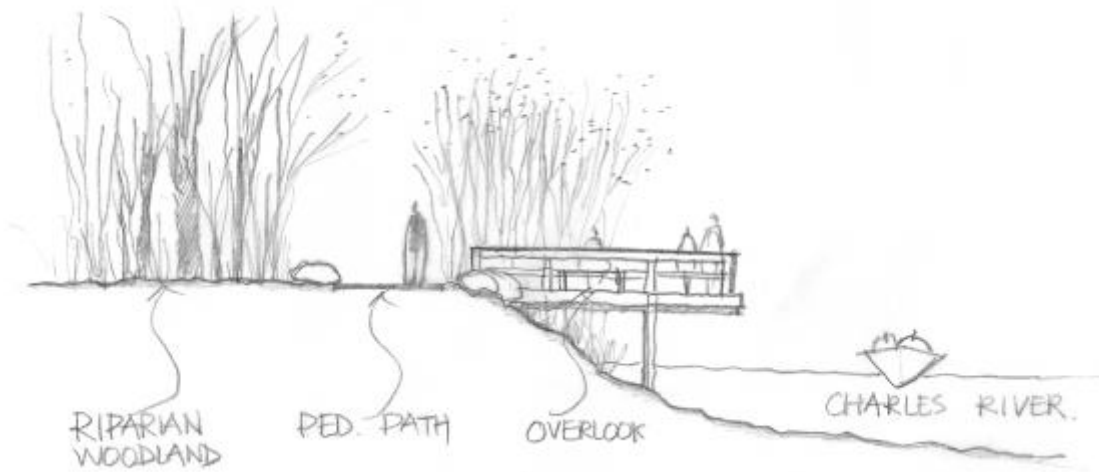

OVERLOOK

RIVER ACCESS TYPE + BANK STABILITY

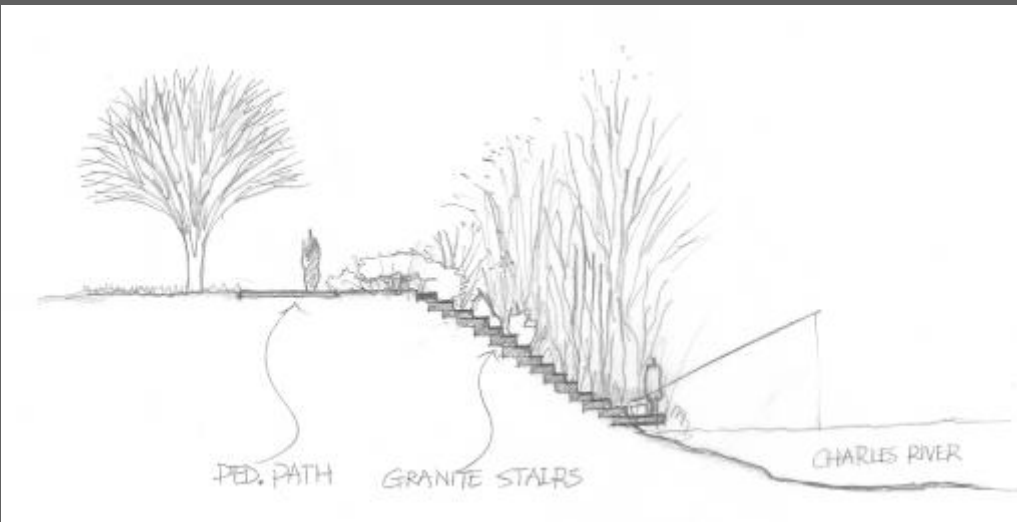

GRANITE STAIRS

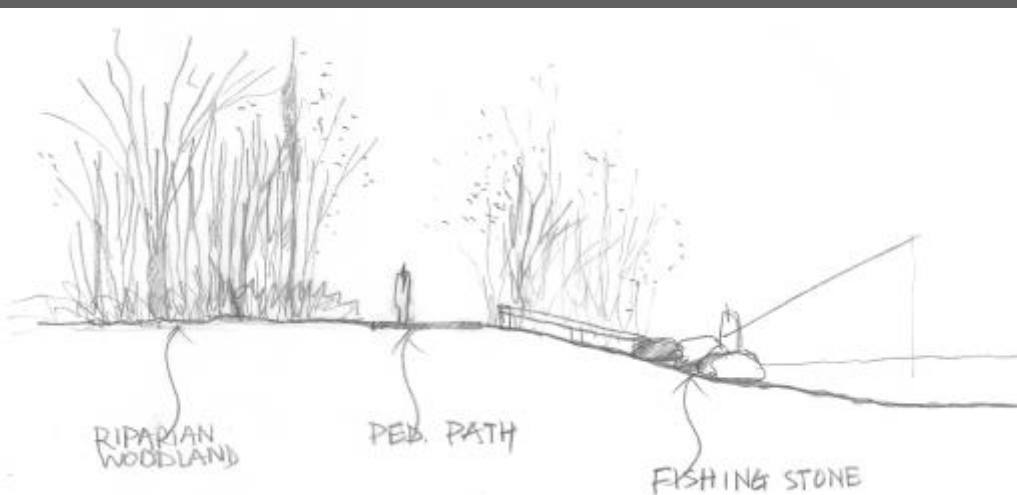

FISHING STONES

RIVER ACCESS TYPE + BANK STABILITY

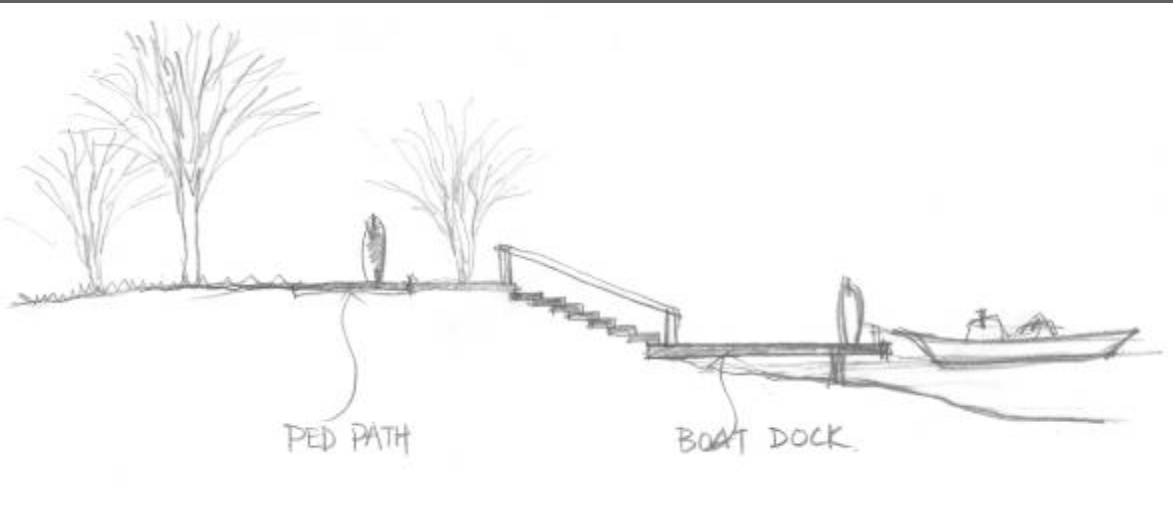

CANOE + KAYAK LAUNCH

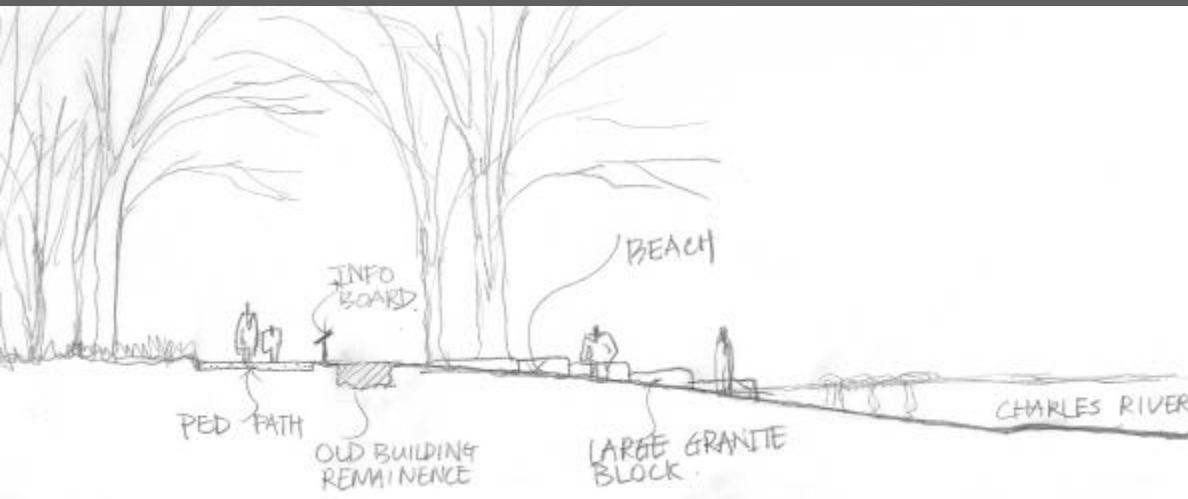

BEACH

PARK ENTRANCE + TRANSITION ZONES

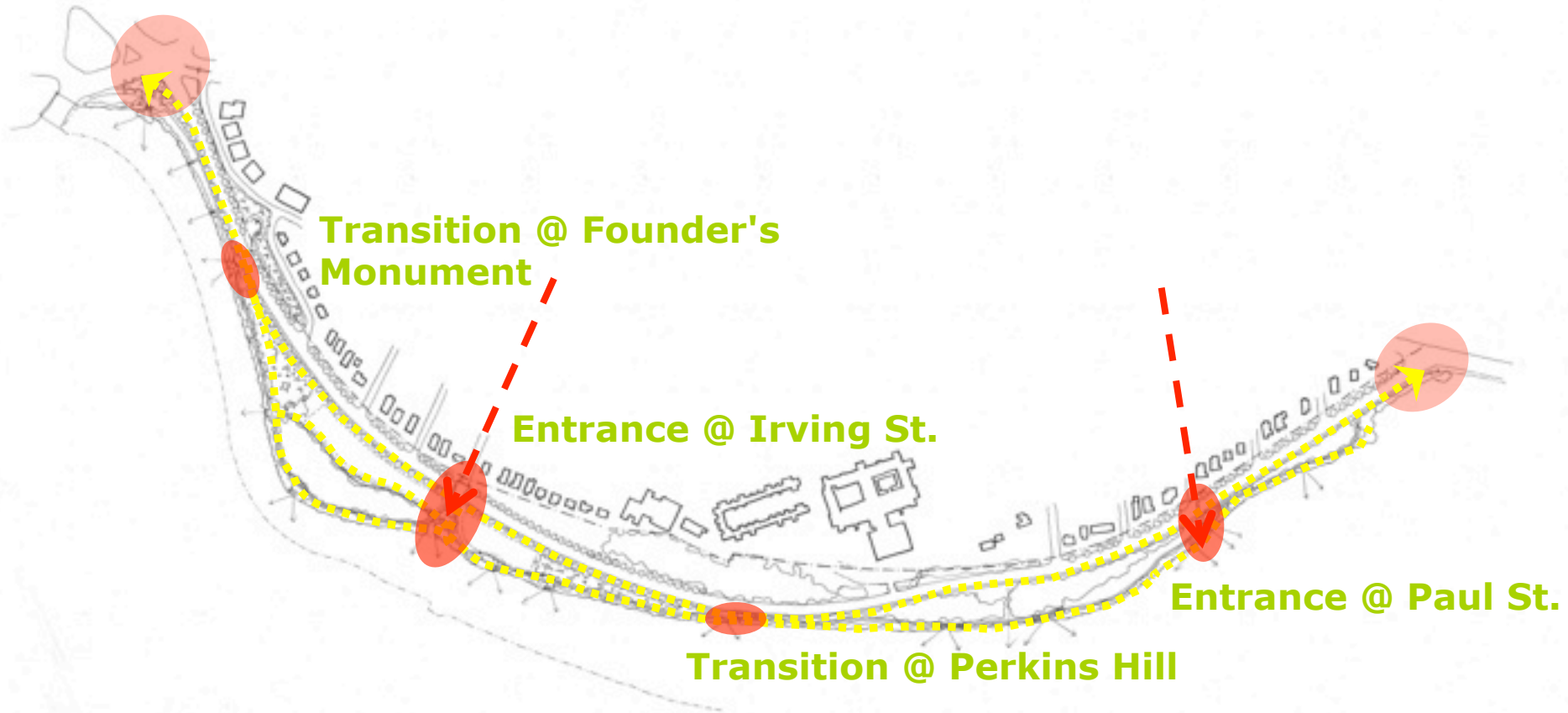

ILLUSTRATIVE PARK PLAN



PARK ENTRANCE @ PAUL STREET



PARK ACCESS

- Yield sign
- Crosswalks
- Curb ramps
- Entry sign
- 5% slope max into park
- Views to the water

PAUL STREET

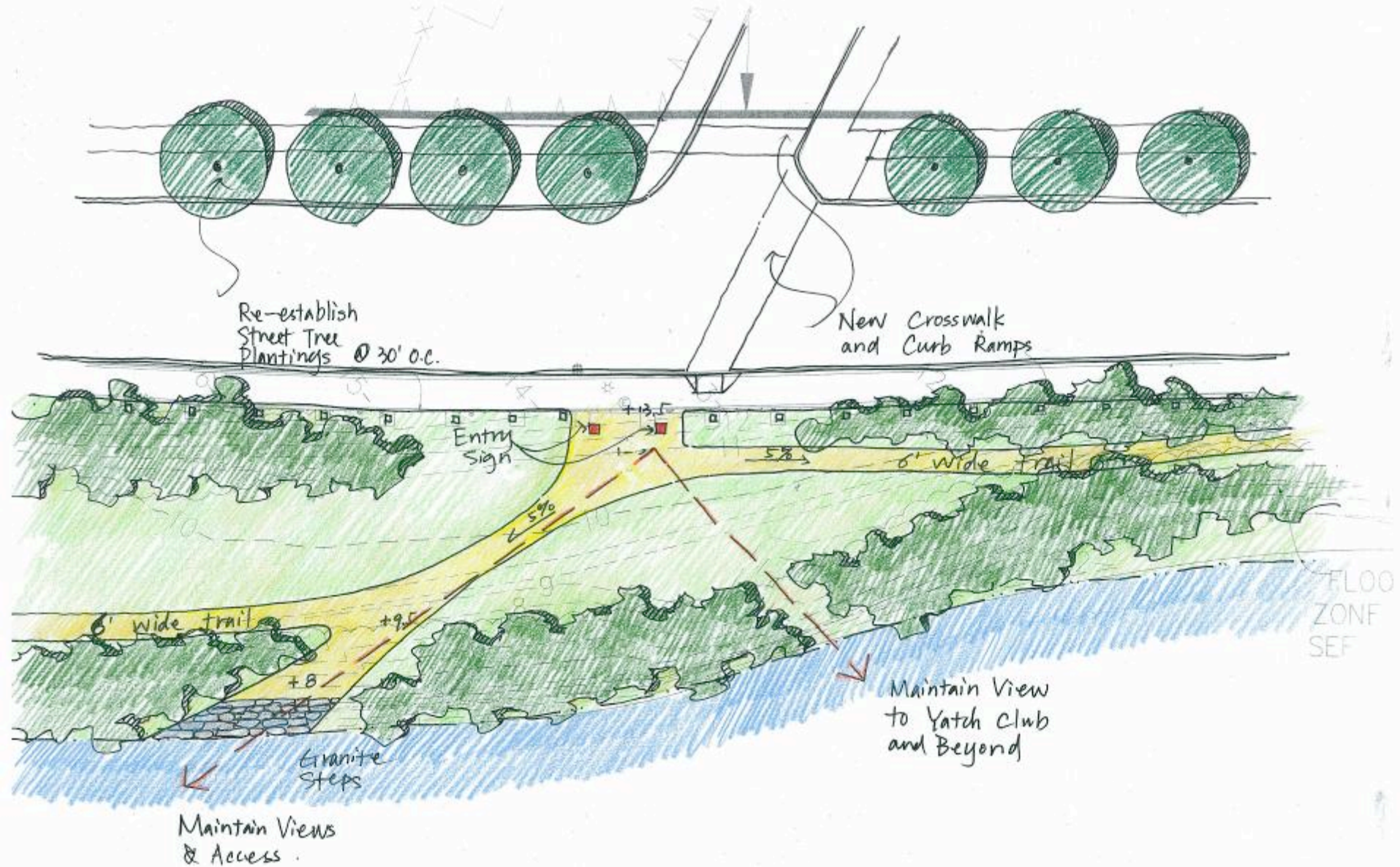

PAUL STREET



ENTRY POST



SOFT PATHWAY



**RIVER ACCESS
GRANITE STAIRS**

PERKINS HILL

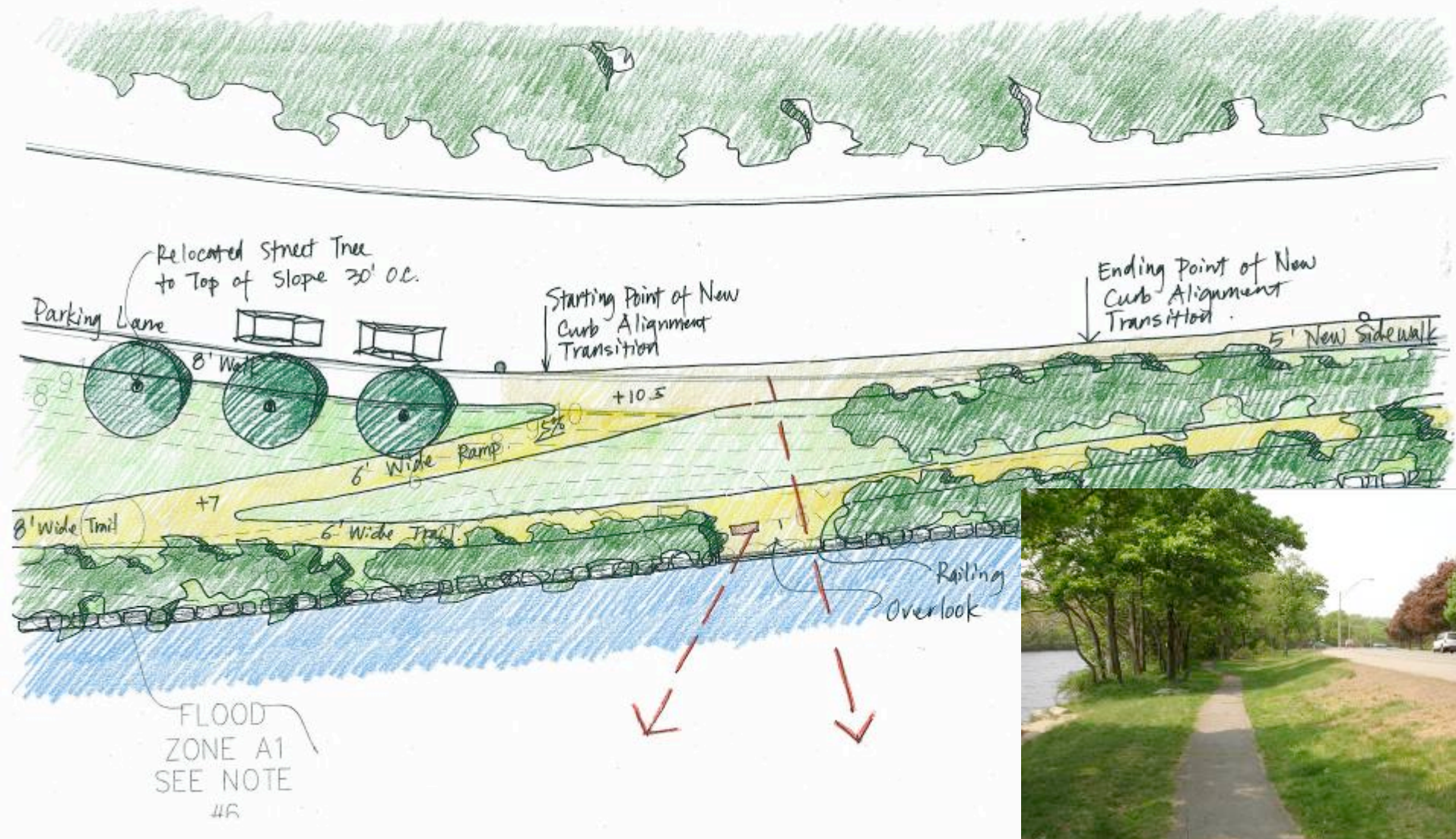

FOUNDER'S MONUMENT

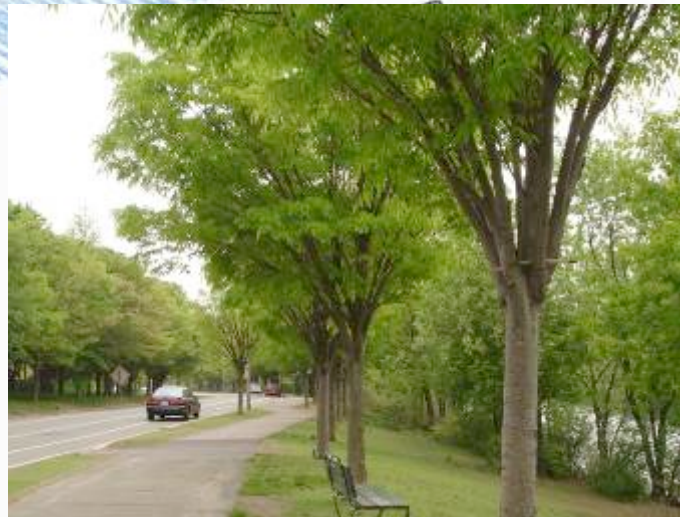
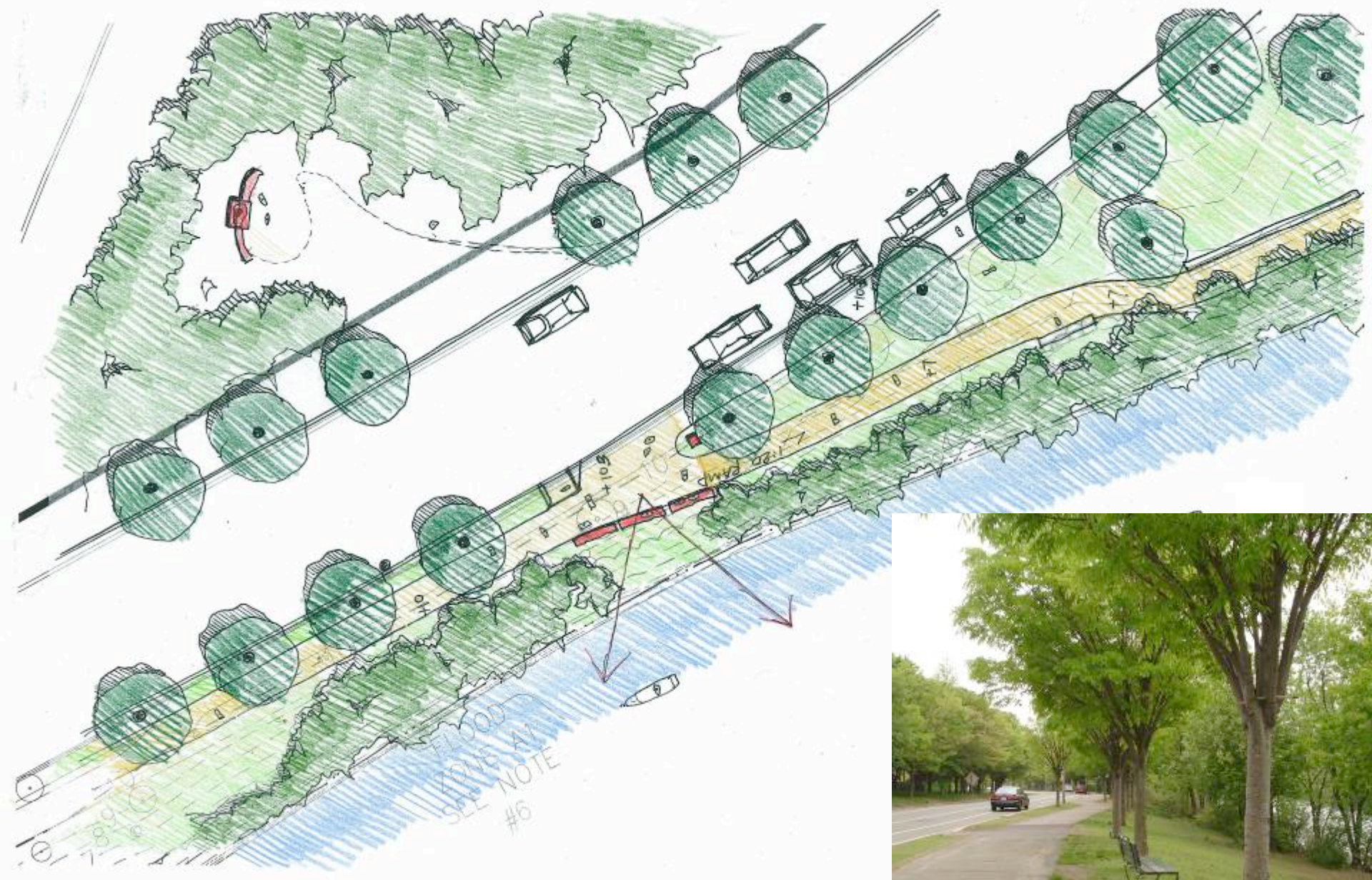

Founders of Watertown Memorial



FOUNDER'S MONUMENT



PARK ENTRANCE @ IRVING STREET



ACCESS

- Pedestrian light
- Crosswalks
- Curb ramps
- Entry sign
- 5% slope max into park
- River view

PROGRAM

- Basketball court + playground to be redesigned and improved
- Braille Trail added
- Expanded playfields
- Access to water

IRVING ENTRANCE AND PLAYGROUND



IRVING STREET



IRVING STREET



OPTION 1
PARK ENTRANCE @ IRVING ST.
1"=10'

OVERLOOK

SOFT PATHWAY

BRaille TRAIL

ENTRY POST



SENSORY TRAIL



SENSORY TRAIL LOOP



SENSORY TRAIL- Wayfinding and interpretation

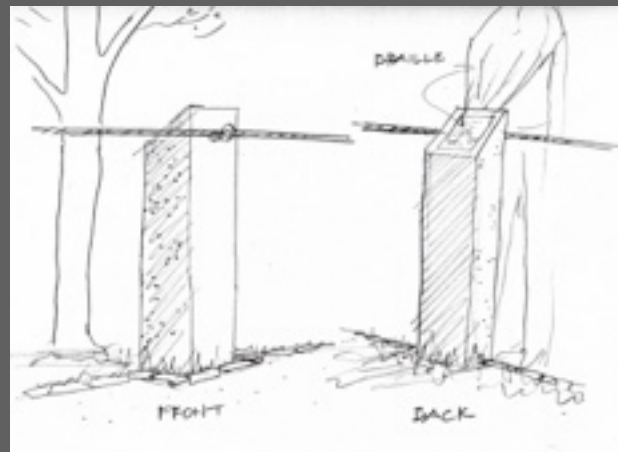

Sensory play

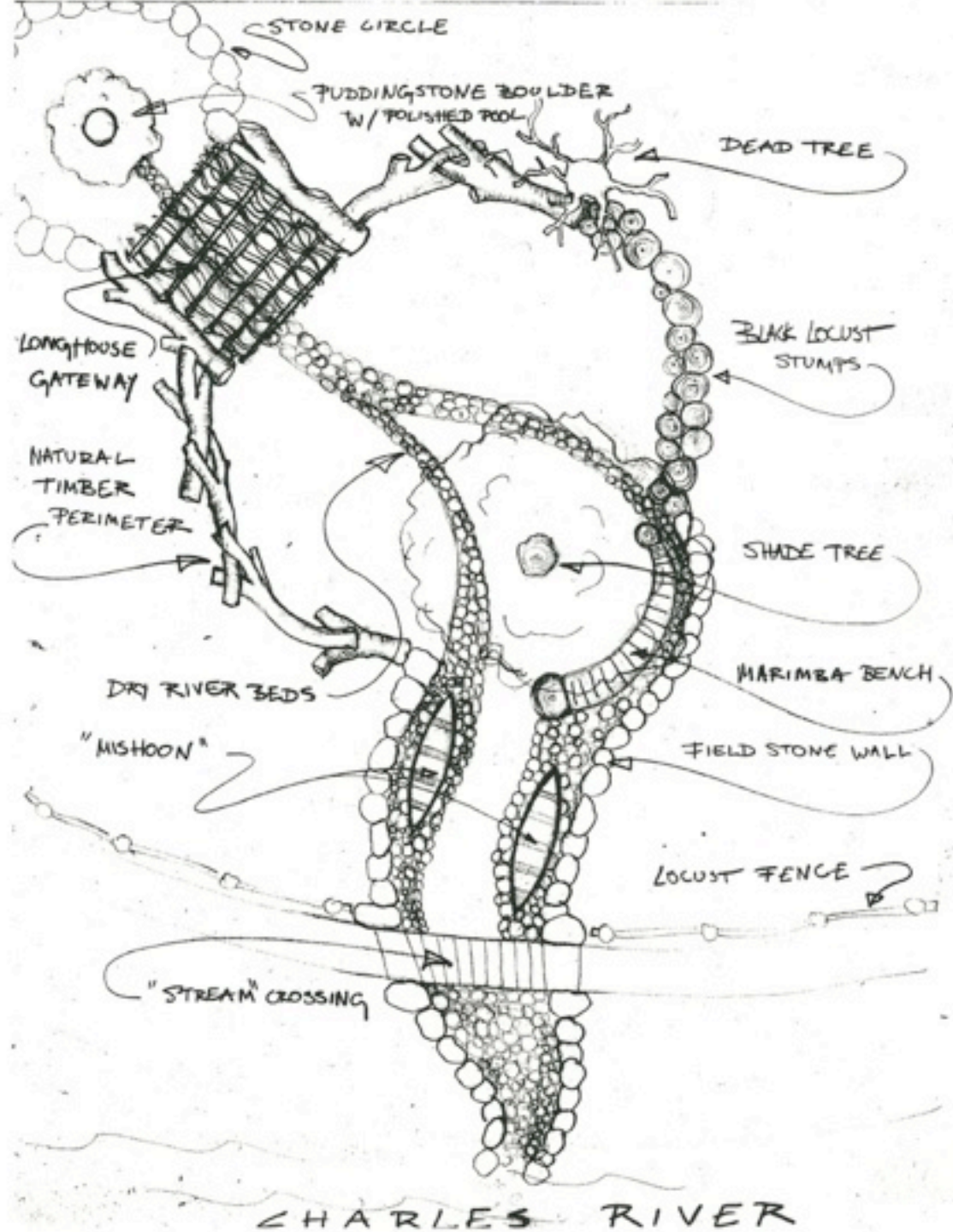

Vessel

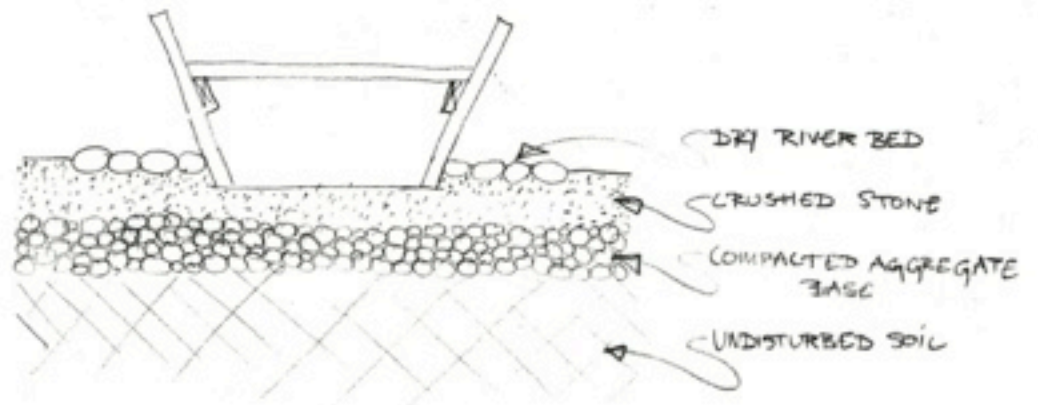
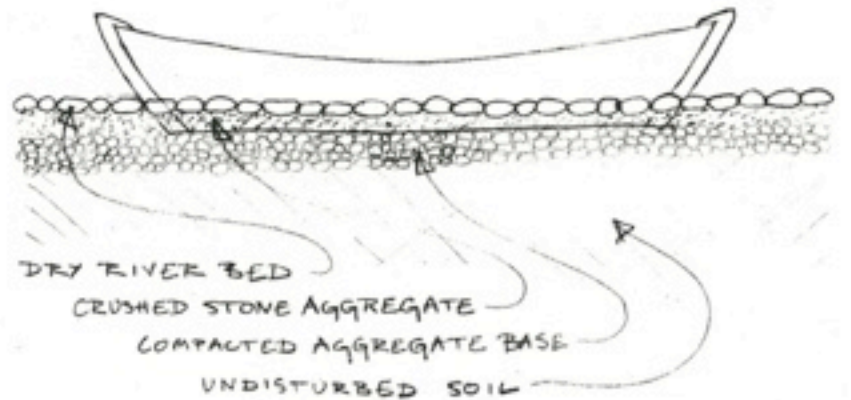
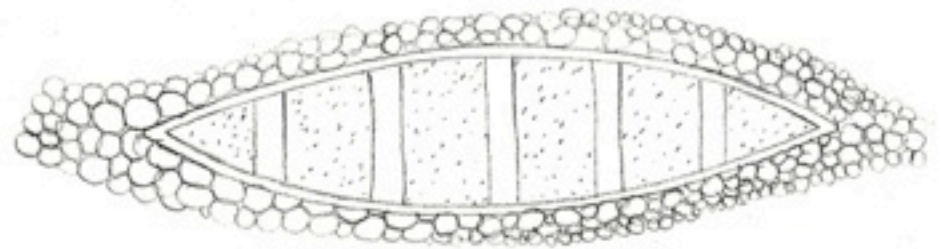

DETAIL OF "MISHOON"

43 MR 7/9/12

Bench

SENSORY TRAIL SINGLE SIDED BENCHES

MR 8/3/12

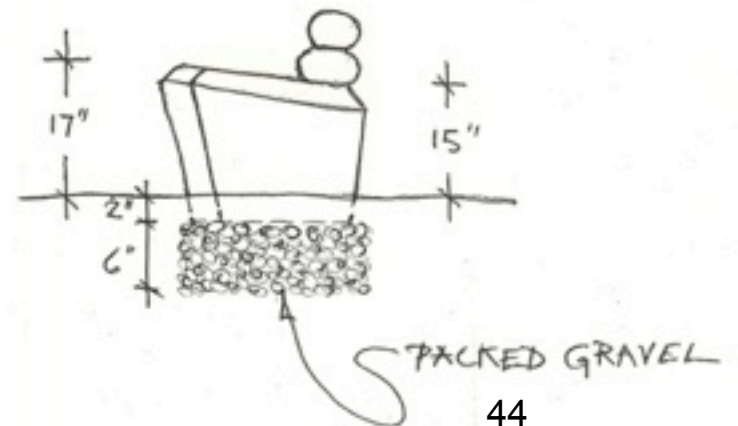
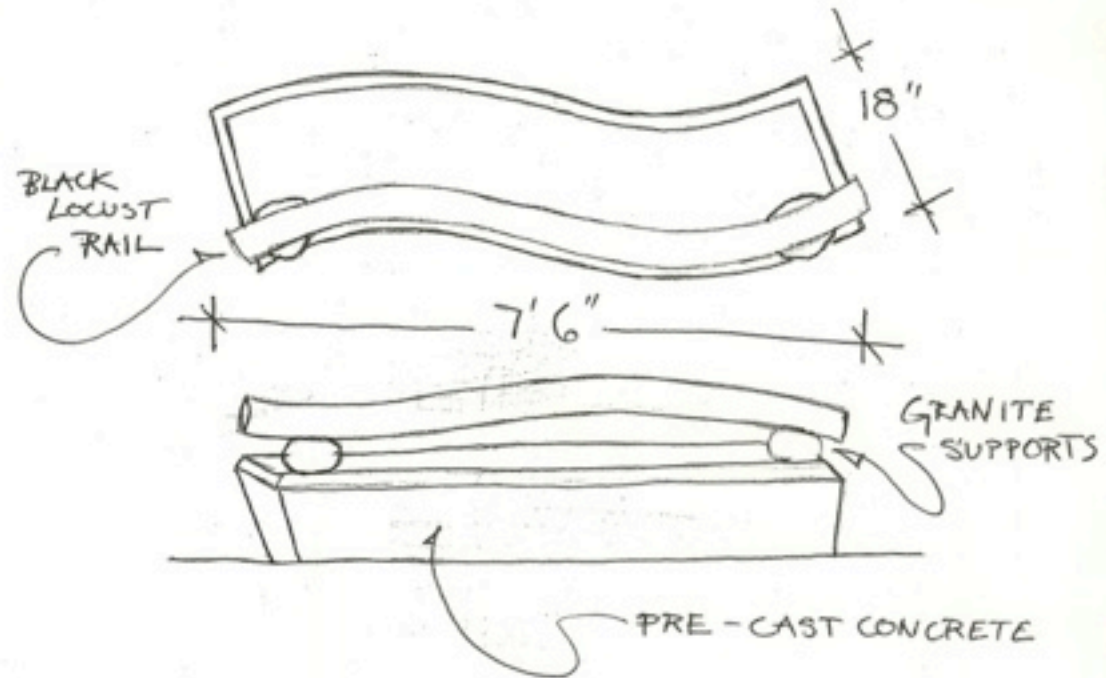

SENSORY TRAIL



Sweet Bay Magnolia



Witch Hazel

COSTS

- **1.9 million dollars** for full implementation
- Possible savings through the donation of granite
- The full costs of planning, design, permitting and administration are being covered by the Lawrence and Lillian Solomon Fund
- Enhanced maintenance to be supported through a volunteer organization with assistance from CRC, TTOR, and the Watertown Community Foundation.



SALTONSTALL GATE

Entry	\$75 K
Bank Stabilization	\$20 K
Granite Steps	\$25 K
Monument	\$40 K
Fishing Stone	<u>\$10 K</u>
\$ 170 K	

IRVING ST GATE

Entry	\$150 K
Bank Stabilization	\$20 K
Wetland	\$55 K
Path	\$165 K
Deck	\$40 K
Beach	\$25 K
Granite Steps	\$35 K
Braille Indicators	\$45 K
Fishing Stone	<u>\$20 K</u>
\$ 555 K	
<i>Signed Crossing</i>	<i>\$135 K</i>
\$ 690 K	

GALLERY PLAY

Demo Court	\$20 K
Path	\$135 K
Road Improvement	\$55 K
Bank Stabilization	\$15 K
Granite Overlook	\$35 K
Gallery Forest	\$35 K
\$ 295 K	
<i>Children's Play</i>	<i>\$205 K</i>
\$ 500 K	

PERKINS HILL

Path	\$105 K
Paul Street	\$40 K
Hiking Trail	\$45 K
Deck	\$40 K
Granite Steps	\$35 K
Fishing Stone	<u>\$10 K</u>
\$ 275 K	

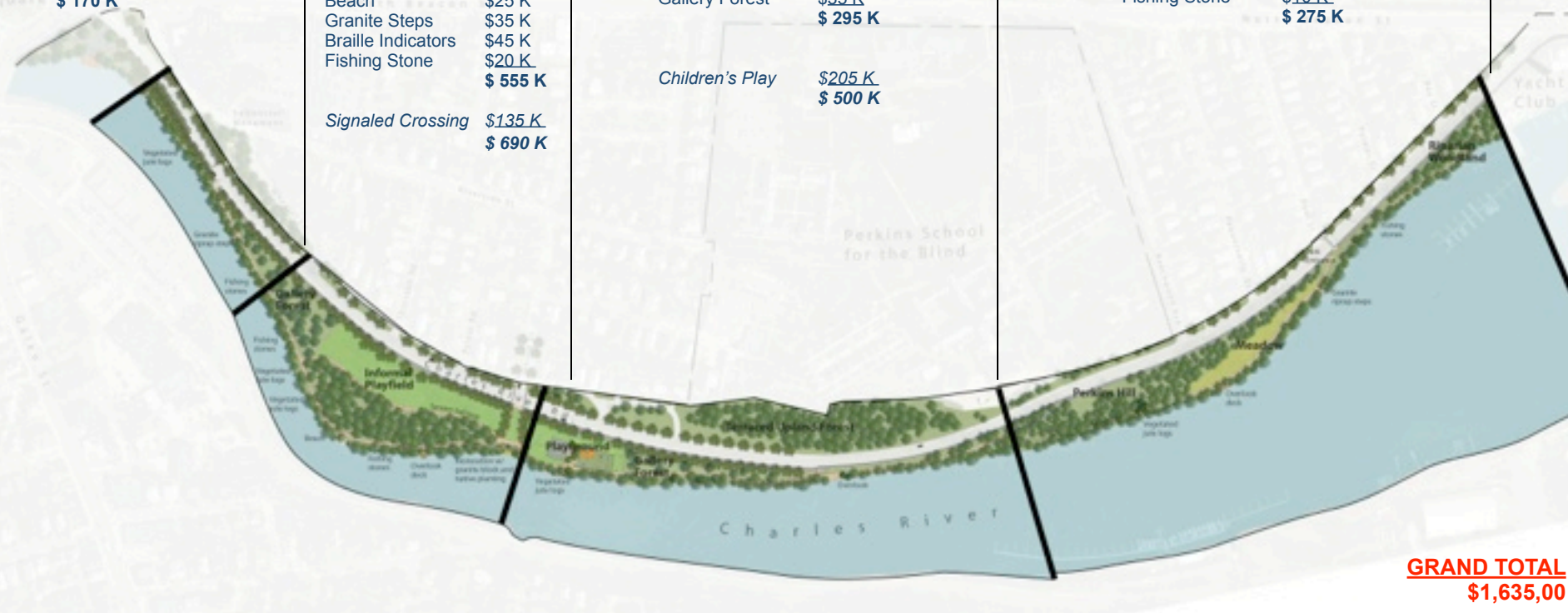

GRAND TOTAL
\$1,635,00



Watertown Riverfront Park Restoration Project
Upper Charles River Basin,
Watertown, Massachusetts



Project timeline

2006 - completed

DCR / Solomon partnership started
Watertown Stewardship group formed
First public meeting – **VISION**
Program statement and RFP drafted

2007 - completed

Sasaki Associates hired
Second Public meeting – **DESIGN**
Friends of Watertown Riverfront formed

2008 - completed

Design development package complete
Friends application for
founders memorial accepted
First Friends volunteer work day

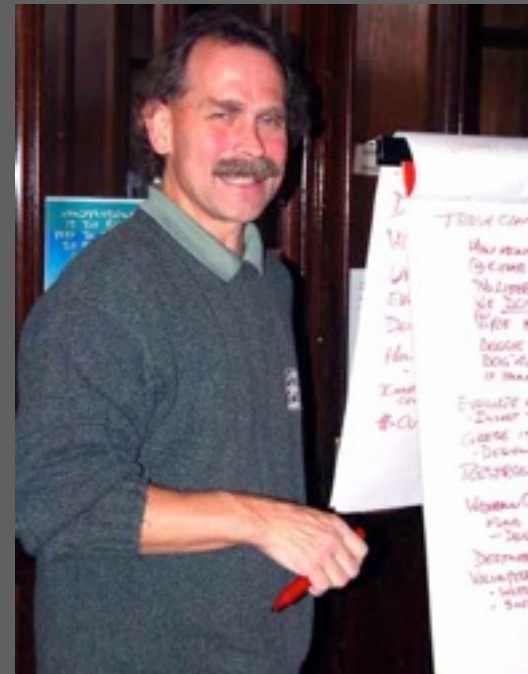

Project timeline

2008 - completed

DCR review of design package

Brief representatives

Funding requests in

Sasaki completes contract documents and permits

Founders memorial restoration completed

2009 - completed

Founders Memorial celebration - June

Funding request for phase one

Restoration to start contingent on funding

2012

Bioengineering joins design team

Mitch Ryerson joins design team

Sensory play space added

Working drawings and permits updated



STEWARDSHIP

- **Friends of the Watertown Riverfront**
- Organized numerous volunteer days last year and had lots of fun doing it.
- TTOR and CRC advising and leading efforts
- Long term commitment to sustainability



The Planning Partnership

The Department of
Conservation and Recreation

The Lawrence and Lillian
Solomon Fund

The Town of Watertown

Perkins School for the Blind

Interested citizens

Designers

Sasaki Associates

Bioengineering

Mitch Ryerson

Stewardship partners to DCR

Friends of the Watertown
Waterfront

Trustees of Reservations

Charles River Conservancy

